



424 ACEQUIA MADRE UNIT 16



On the Historic Eastside



LIVING & DINING

⇒ Renovated Kitchen ⇒ Kiva Fireplaces ⇒ Covered Portal



424 ACEQUIA MADRE UNIT 16

3 Bedroom • 2 Bath • 1732 SF • \$850,000 • MLS# 202004105

Recently renovated 3 bedroom 2 bathroom condo tucked away near downtown Santa Fe on the Historic Eastside. Private, brick-lined courtyard with rustic hand-carved wood gate and covered portal. The character and history of the Southwest flow into the living room with viga ceilings, wood floors, and a kiva fireplace, one of five kivas in the home. The renovated kitchen is appointed with custom wood cabinetry, butcherblock countertops, recently added stainless steel appliances, and an intimate breakfast nook. Split bedroom plan with two adjoining bedrooms on one side of the home with a third bedroom or multi-flex space on the other. Extra closet space recently added and laundry room reconfigured. The bathrooms feature subway tile throughout, porcelain vanity, and tub and shower combo. Wood floors throughout. Private brick-lined front courtyard, covered storage, 1 car garage and 3 carport parking spaces. Perfect pied-a-terre or investment opportunity. Close to the state capitol, Canyon Road and the Plaza.

DARLENE STREIT | 505.920.8001 | DSTREIT@DSTREIT.COM



B E D R O O M S

⇒ Split Bedroom Plan ⇒ Extra Closet Space ⇒ Wood Floors



DETAILS

- 3 Bedrooms
- 2 Full Baths
- 1732 SF
- .05 Acre
- Adobe and possibly other materials, Frame, Stucco Construction *
- Flat, Membrane Roof
- 1 Garage Space
- 3 Carport Parking Spaces
- 5 Fireplaces
- Gas Cooking
- Forced Air, Gas Heating
- Refrigerator, Central Cooling
- City Sewer
- City Water
- Internet: Cable, DSL
- Insulated Windows
- HOA Fees: \$525 Per Quarter
- HOA Fees Cover: Community Area & Road Maintenance, Insurance
- Security System
- Drip/Sprinkler System

*Buyer to Verify

424 ACEQUIA MADRE UNIT 16 - FLOOR PLAN
This depiction is for illustration purposes and may not be entirely accurate



464 ACEQUIA MADRE #16 - PLAT
This depiction is for illustration purposes and may not be entirely accurate

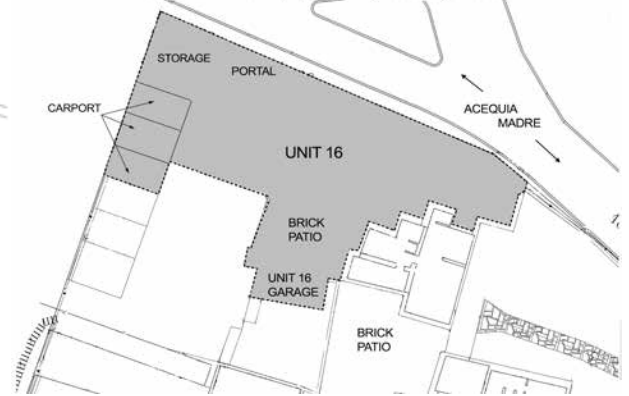

DARLENE STREIT

SANTA FE REAL ESTATE PROPERTY



DARLENE STREIT
505.920.8001 • dstreit@dstreit.com
Office: 417 E. Palace Avenue
Santa Fe NM 87501

SantaFeRealEstateProperty.com

DarleneStreit.com

SantaFeLuxuryHomesandLand.com



View
Listing
Online

© Sotheby's International Realty, Inc. All rights reserved. Sotheby's International Realty® is a registered trademark. This material is based upon information which we consider reliable but because it has been supplied by third parties, we cannot represent that it is accurate or complete and it should not be relied upon as such. This offering is subject to errors, omissions, changes including price or withdrawal without notice. If your property is listed with a real estate broker, please disregard. It is not our intention to solicit the offerings of other real estate brokers. We are happy to work with them and cooperate fully. Operated by Sotheby's International Realty, Inc. Real estate agents affiliated with Sotheby's International Realty, Inc. are independent contractor sales associates and are not employees of Sotheby's International Realty, Inc. Equal Housing Opportunity. Sotheby's International Realty, 326 Grant Ave, Santa Fe, NM 87501, 505-988-2533.

Sotheby's
INTERNATIONAL REALTY